

Eastern Area Planning Committee

7th October 2021

7a) PL/2021/04596 West Winds, 72 Netherstreet, Bromham, Chippenham, SN15 2DP

Outline application for demolition of bungalow and replacement with 2 no. detached dwellings and associated works to include change of use of land to form extended residential curtilage.

Recommendation: Approve with Conditions



Site Location Plan



Aerial Photography





LOCATION PLAN

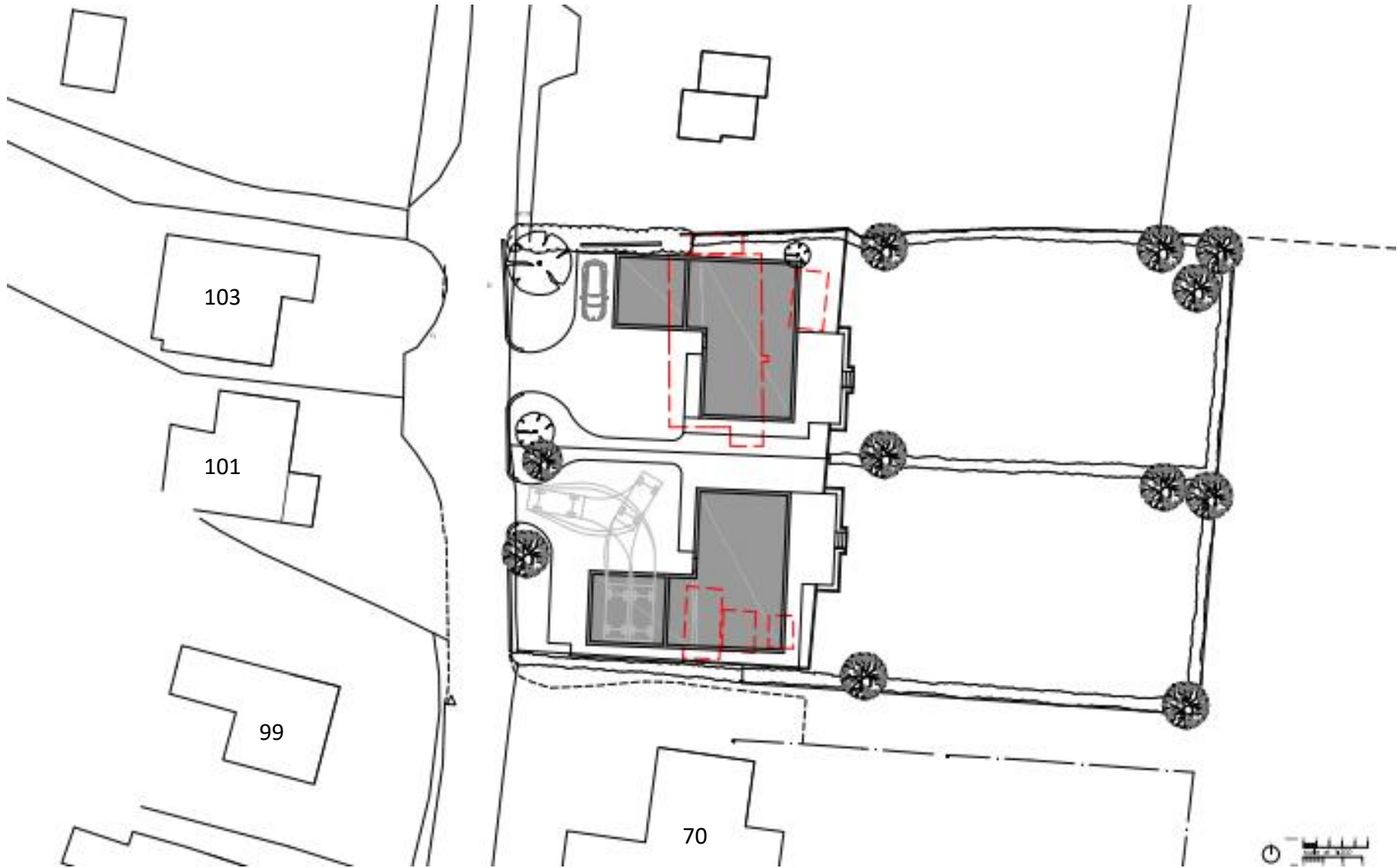

INDICATIVE SITE LAYOUT PLAN

(outline of existing bungalow and sheds in red)



NETHER STREET

76

103

101

99

70

68

Application Site

© Google

Image date September 2020

AERIAL VIEW 2020



EXISTING BUNGALOW – FRONT ELEVATION



BUNGALOW VIEWED FROM THE OPPOSITE SIDE OF THE STREET



APPLICATION SITE/ BUNGALOW

76

99

101

STREET SCENE FACING SOUTH



APPLICATION SITE/ BUNGALOW ✕

99

101

76

72

70

STREET VIEW FACING NORTH

© Google



NEIGHBOURING PAIR OF PROPERTIES TO THE SOUTH – 70 & 68



OPPOSITE PAIR OF PROPERTIES – 101 & 103

Eastern Area Planning Committee

7th October 2021